

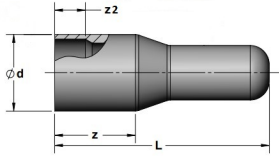

**BUTT FITTINGS END CAPS:
PE2708, IPS, DR13.5 Style 2**

- Approval: ASTM D2513
- Approval: ASTM D3261
- Approval: CSA B137.4 (indicated with *)



Size (inch)	GF Code	weight (lb)	CSA	d (inch)	L (inch)	z (inch)	z2 (inch)	Box Qty
4	360 000 345	1.4		4.50	7.75	3.00	1.00	10
6	360 000 354	4.0		6.63	10.25	4.22	1.37	5
8	360 000 366	7.8	*	8.63	12.41	5.14	2.20	6

The technical data are not binding. They neither constitute expressly warranted characteristics nor guaranteed properties nor a guaranteed durability. They are subject to modification. Our General Terms of Sale apply.

Georg Fischer Piping Systems Ltd, Postfach, CH-8201 Schaffhausen/Switzerland

Phone +41 -(0)52-631 1111

e-mail: info.ps@georgfischer.com

Internet: <http://www.gfps.com>