

## BUTT FITTINGS 90° ELBOWS: PE2708, IPS, DR9.3

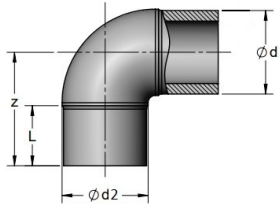

- Approval: ASTM D2513
- Approval: ASTM D3261
- Approval: CSA B137.4 (indicated with \*)
- Approval: IAPMO (indicated with \*)



Main Size (inch)	GF Code	weight (lb)	CSA	IAPMO	d (inch)	d2 (inch)	L (inch)	z (inch)	Box Qty
0.75	<b>360 000 231</b>	0.1	*	*	1.05	1.22	2.03	3.06	100
1	<b>360 000 237</b>	0.2			1.32	1.48	1.88	3.15	100
1.25	<b>360 000 240</b>	0.3	*	*	1.66	1.84	1.95	3.86	100
1.5	<b>360 000 244</b>	0.4		*	1.90	2.08	2.33	4.02	80

The technical data are not binding. They neither constitute expressly warranted characteristics nor guaranteed properties nor a guaranteed durability. They are subject to modification. Our General Terms of Sale apply.

Georg Fischer Piping Systems Ltd, Postfach, CH-8201 Schaffhausen/Switzerland

Phone +41 -(0)52-631 1111

e-mail: [info.ps@georgfischer.com](mailto:info.ps@georgfischer.com)

Internet: <http://www.gfps.com>