



BROEN is part of the stock listed company Aalberts N.V. Since the inception in 1975, Aalberts is where technology matters and real progress can be made - humanly, financially and environmentally. At Aalberts, we create mission-critical technologies for ground-breaking industries and everyday life. Technologies that enhance our clients' businesses and keep our planet in good shape.

WHO WE ARE

Large and small, high or low pressure, BROEN always has the valve you need.

Founded in 1948 by Denmark's Poul **BROEN**, **BROEN** today is a global valve manufacturing group of companies. For more than 70 years, **BROEN** has been the leader in the development and production of valve technology for water, air and gas. Our goal is to build long-lasting and trust-based partnerships with our valued Customers, through the local presence of our companies and our capillary sales and service network.

BROEN employs more than 600 employees in five manufacturing facilities worldwide, producing more than three million valves per year.

ISO 9001 certified since 2001, **BROEN** is committed to ensuring our Customers receive high-quality products that exceed expectations.

BROEN has a strong focus on innovation, continuously improving our product range to offer state-of-the-art solutions and technologies, including **BROEN BALLOMAX**®, the industries' best ball valves for natural gas service.

The **BROEN BALLOMAX** Valves



Floating ball valves



Trunnion and API-6D monogrammed ball valves



Polyethylene (PE) valves



FLOATING BALL VALVES

BROEN BALLOMAX®, floating ball valves are designed specifically for natural gas distribution systems.

BROEN BALLOMAX® floating ball valves are the best choice when it comes to steel ball valves for natural gas distribution systems.

All our floating ball valves feature an all-welded body with no potential leak path. Our valves are long lasting and maintenance-free.

BROEN offers virtually endless configurations and customizations to meet all your needs:

- Pressure rating (MOP): 285 PSI, 500 PSI, 740 PSI
- Port size: Regular and Full port
- Ball type: Concave and Straight
- End connections: any option. Weld ends are A106 Gr. B. Flanges are ANSI B16.5 A105 Gr. B.
- Operators: all operators available. Valve actuators and gear operators are also available.

Standard ball and stem are stainless steel.

Maximum safety is granted by the anti-blow out stem design. Moreover, all valves are equipped with "safety grounded stem" that removes any risk of static build up and resulting arc.

The sealing is granted by carbon filled PTFE seats for zero-leakage. To prevent stem leaks all valves are supplied with a redundant stem sealing system.

Each valve features a unique serial number permanently stamped on the nameplate, allowing for full traceability.

Valves can accommodate a standard barrel lock or standard pad locks.

All valves are hydrostatically tested per API-6D: shell test and seat test. Additional low-pressure air test is performed to ensure tight sealing performance. Other tests available at Customer's request. Test certificates are available for each valve.

Valves are equipped with POWERSTOPS™ preventing valve over-torque.

Valves 2" to 8" are tested per API 641 for fugitive emissions.

THREE DIFFERENT STYLES:

- **Pipeline style:** the **BROEN** best-seller with endless configurations to fit most requirements.
- **Premium style:** high-end valve made with extra-strong forged components. Short-pattern design is ideal for metering and regulating stations.
- **Utility style:** Cost-effective short pattern flanged end ball valve. Ideal to replace plug and iron body valves.

Valve modifications available at our shop in Houston, Texas include:

- Specialty coatings
- Stem extensions
- Valves with special length and extended pups
- Valves with gears, actuators, limit switches, etc.

Please contact us for any valve needs you may have.

State-of-the-art ball valves
for natural gas distribution

CATALOG NUMBERING SYSTEM

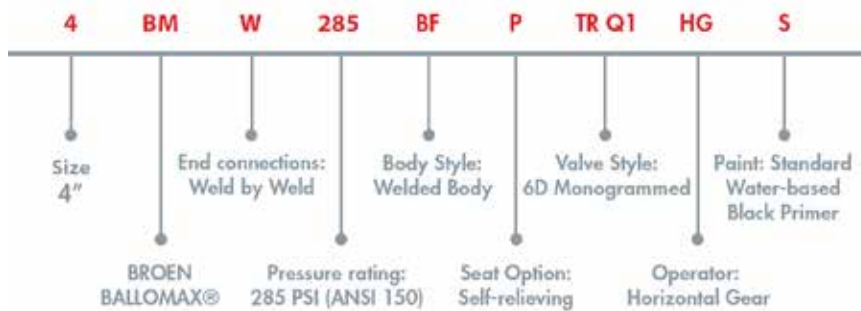

- | | | |
|---------------------------------|--------------------|---------------------------------|
| 1. Size [inch] | 5. Valve style | 9. Operator |
| 2. BROEN BALLOMAX® (BM) | PL (Pipeline) | 25 (curb nut) |
| 3. End configuration | PR (Premium) | 14 (2" nut) |
| W (weld end) | UV (Utility) | HG (horizontal gear) |
| F (flanged end) | 7. Port | VG (vertical gear) |
| WF (weld x flange) | RP (regular port) | 10. Paint |
| HT (hot tap) | FP (full port) | S (standard water-based primer) |
| FT (female thread) | 8. Ball | 3M (3M 323) |
| WM (weld x MPT thread) | CB (concave ball) | B (coal tar enamel) |
| 4. Pressure [PSI] 285, 500, 740 | SB (straight ball) | |

BROEN reserves the right to change any information included in this catalog without notice.



PIPELINE



PREMIUM

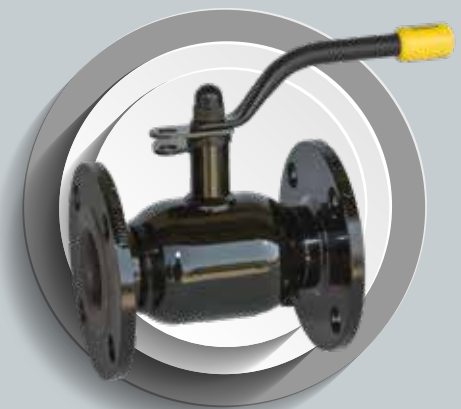

UTILITY

COMPONENTS AND MATERIALS



1. Powerstop (heat treated steel)
2. Stem seals (Viton Buna N and NBR)
3. Lock wing flange
4. Stainless steel stamped label
5. 2" square nut w/lock wing
6. Weather seal (Buna N gasket)
7. Steel travel stop pin
8. Stainless steel stem
9. Body stem friction washer
10. Carbon steel pipe body
11. Stainless steel ball
12. Seat ring (Teflon/PTFE)
13. Seat o-ring (Buna N o-rings)
14. Seat support ring
15. Stainless steel Belleville® spring
16. Protective end cap
17. Carbon steel (A 106 Gr. B) end connections
18. Stem bearing (zinc coated)

SEAT SPECIFICATION

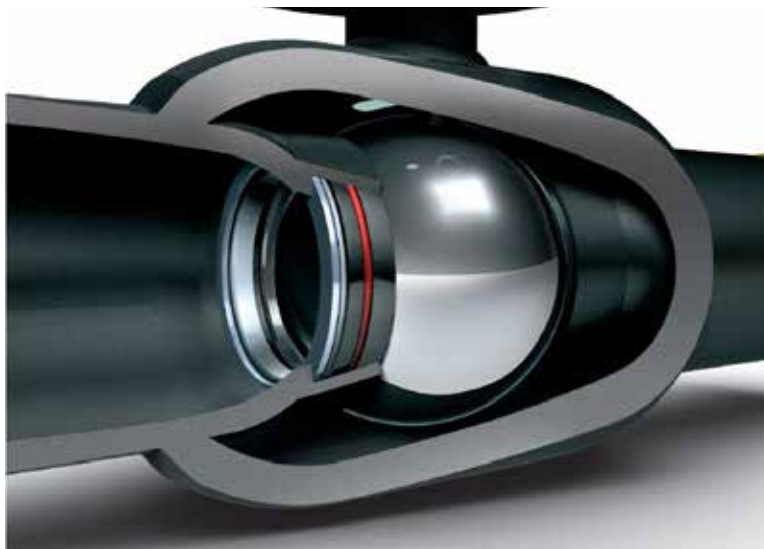

SEAT QUALITY FEATURES

- Does not absorb water and does not expand
- Chemical resistant
- High friction characteristics
- Good temperature stability
- Tested and approved up to 482°F

SEAT SPECIFICATION

The base material: PTFE powder
 Type of material: G453
 Particle size: 60 micron part
 Size of filler: 40 micron
 Type of filler: Carbon
 Mix: PTFE +20% carbon
 tolerance of content: ±5%

BROEN reserves the right to change any information included in this catalog without notice.

PIPELINE

The BROEN best-seller with endless configurations to fit most requirements

TO BE WELDED 2 PLACES
180° APART
WELD: .12", 1/2" LONG.

Fully welded, carbon steel, regular port floating ball valves, designed specifically for natural gas.

Manufactured from the same pipe material as your pipeline, they can be used in below ground or above ground applications.

These valves feature:

- Stainless steel balls and stem standard
- Quarter-turn operations
- Locking plate with POWERSTOPS™ 600 ft/lbs
- Seats of 25% carbonized PTFE (Teflon™) (G-453) rated to -20°F
- Zinc coated stem bearings
- Tested per API-6D requirements
- Serial numbered for full traceability



BROEN reserves the right to change any information included in this catalog without notice.

PIPELINE

REGULAR PORT

WELD X WELD – 285 PSI – ANSI 150					
Size	Catalog number	Port	Length	Wall	Weight
3/4" ⁽¹⁾	3/4BMW285PLRPSB25S	0.59	9.02	0.113	3
3/4"	3/4BMW285PLRPSB14S	0.59	9.02	0.113	5
1" ⁽¹⁾	1BMW285PLRPSB25S	0.79	9.06	0.133	4
1"	1BMW285PLRPSB14S	0.79	9.06	0.133	6
1-1/4"	5/4BMW285PLRPSB14S	1.00	10.24	0.140	7
2"	2BMW285PLRPCB14S	1.54	11.81	0.154	10
3"	3BMW285PLRPCB14S	2.48	14.60	0.216	18
4"	4BMW285PLRPCB14S	3.07	15.35	0.237	25
6"	6BMW285PLRPCB14S	4.90	15.35	0.280	56
8" ⁽²⁾	8BMW285PLRPCB14S	5.75	15.35	0.322	131
8" ⁽³⁾	8BMW285PLRPCBHGS	5.75	15.35	0.322	161

WELD X WELD – 740 PSI – ANSI 300					
Size	Catalog number	Port	Length	Wall	Weight
3/4"	3/4BMW740PLRPSB25S	0.59	9.02	0.113	3
3/4"	3/4BMW740PLRPSB14S	0.59	9.02	0.113	5
1"	1BMW740PLRPSB25S	0.79	9.06	0.133	4
1"	1BMW740PLRPSB14S	0.79	9.06	0.133	6
1-1/4"	5/4BMW740PLRPSB14S	1.00	10.24	0.140	8
2"	2BMW740PLRPCB14S	1.54	11.81	0.154	13
3"	3BMW740PLRPCB14S	2.48	14.57	0.216	25
4"	4BMW740PLRPCB14S	3.07	15.35	0.237	35
6"	6BMW740PLRPCB14S	4.90	15.35	0.280	70
8" ⁽²⁾	8BMW740PLRPCB14S	5.75	15.40	0.322	131
8" ⁽³⁾	8BMW740PLRPCBHGS	5.75	15.40	0.322	161

WELD X FLANGE – 285 PSI – ANSI 150					
Size	Catalog number	Port	Length	Wall	Weight
2"	2BMWF285PLRPCB14S	1.54	9.50	0.154	16
3"	3BMWF285PLRPCB14S	2.48	12.20	0.216	26
4"	4BMWF285PLRPCB14S	3.07	13.11	0.237	35
6"	6BMWF285PLRPCB14S	4.90	13.68	0.280	77
8" ⁽²⁾	8BMWF285PLRPCB14S	5.75	15.90	0.322	140
8" ⁽³⁾	8BMWF285PLRPCBHGS	5.75	15.90	0.322	170

WELD X FLANGE – 740 PSI – ANSI 300					
Size	Catalog number	Port	Length	Wall	Weight
2"	2BMWF740PLRPCB14S	1.54	10.16	0.154	19
3"	3BMWF740PLRPCB14S	2.48	12.85	0.216	38
4"	4BMWF740PLRPCB14S	3.07	13.68	0.237	56
6"	6BMWF740PLRPCB14S	4.90	15.61	0.280	104
8" ⁽²⁾	8BMWF740PLRPCB14S	5.75	15.90	0.322	189
8" ⁽³⁾	8BMWF740PLRPCBHGS	5.75	15.90	0.322	217

FLANGE X FLANGE – 285 PSI – ANSI 150					
Size	Catalog number	Port	Length	ANSI	Weight
2"	2BMF285PLRPCB14S	1.54	7.00	150	18
3"	3BMF285PLRPCB14S	2.48	8.00	150	31
4"	4BMF285PLRPCB14S	3.07	9.00	150	43
6"	6BMF285PLRPCB14S	4.90	10.50	150	81
8" ⁽²⁾	8BMF285PLRPCB14S	5.75	11.50	150	158
8" ⁽³⁾	8BMF285PLRPCBHGS	5.75	11.50	150	188

FLANGE X FLANGE – 740 PSI – ANSI 300					
Size	Catalog number	Port	Length	ANSI	Weight
2"	2BMF740PLRPCB14S	1.54	8.50	300	25
3"	3BMF740PLRPCB14S	2.48	11.13	300	50
4"	4BMF740PLRPCB14S	3.07	12.00	300	75
6"	6BMF740PLRPCB14S	4.90	15.87	300	139
8" ⁽²⁾	8BMF740PLRPCB14S	5.75	16.50	300	247
8" ⁽³⁾	8BMF740PLRPCBHGS	5.75	16.50	300	277

Dimensions listed in inch and pound

- ⁽¹⁾ curb nut
- ⁽²⁾ w/nut
- ⁽³⁾ Standard with horizontal gear operator

BROEN reserves the right to change any information included in this catalog without notice.

PIPELINE

FULL PORT CONCAVE BALL

WELD X WELD – 285 PSI – ANSI 150					
Size	Catalog number	Port	Length	Wall	Weight
2"	2BMW285PLFPCB14S	1.93	11.81	0.154	13
4"	4BMW285PLFPCB14S	3.86	15.35	0.237	35
6"	6BMW285PLFPCB14S	5.75	15.88	0.280	110

WELD X FLANGE – 285 PSI – ANSI 150					
Size	Catalog number	Port	Length	Wall	Weight
2"	2BMWF285PLFPCB14S	1.93	10.16	0.154	17
4"	4BMWF285PLFPCB14S	3.86	13.10	0.237	44
6"	6BMWF285PLFPCB14S	5.75	15.88	0.280	120

FLANGE X FLANGE – 285 PSI – ANSI 150					
Size	Catalog number	Port	Length	ANSI	Weight
2"	2BMF285PLFPCB14S	1.93	8.50	150	22
4"	4BMF285PLFPCB14S	3.86	12.00	150	57
6"	6BMF285PLFPCB14S	5.75	15.88	150	130

WELD X WELD – 740 PSI – ANSI 300					
Size	Catalog number	Port	Length	Wall	Weight
2"	2BMW740PLFPCB14S	1.93	11.81	0.154	13
4"	4BMW740PLFPCB14S	3.86	15.35	0.237	35
6"	6BMW740PLFPCB14S	5.75	15.88	0.280	110

WELD X FLANGE – 740 PSI – ANSI 300					
Size	Catalog number	Port	Length	Wall	Weight
2"	2BMWF740PLFPCB14S	1.93	10.16	0.154	19
4"	4BMWF740PLFPCB14S	3.86	13.10	0.237	55
6"	6BMWF740PLFPCB14S	5.75	15.88	0.280	147

FLANGE X FLANGE – 740 PSI – ANSI 300					
Size	Catalog number	Port	Length	ANSI	Weight
2"	2BMF740PLFPCB14S	1.93	8.50	300	26
4"	4BMF740PLFPCB14S	3.86	12.00	300	75
6"	6BMF740PLFPCB14S	5.75	15.88	300	180

PIPELINE

FULL PORT STRAIGHT BALL

WELD X WELD – 285 PSI – ANSI 150					
Size	Catalog number	Port	Length	Wall	Weight
2"	2BMW285PLFPSB14S	1.93	11.81	0.154	14
4"	4BMW285PLFPSB14S	3.86	15.35	0.237	37
6"	6BMW285PLFPSB14S	5.75	15.88	0.280	117

WELD X FLANGE – 285 PSI – ANSI 150					
Size	Catalog number	Port	Length	Wall	Weight
2"	2BMWF285PLFPSB14S	1.93	10.16	0.154	19
4"	4BMWF285PLFPSB14S	3.86	13.1	0.237	47
6"	6BMWF285PLFPSB14S	5.75	15.88	0.280	130

FLANGE X FLANGE – 285 PSI – ANSI 150					
Size	Catalog number	Port	Length	ANSI	Weight
2"	2BMF285PLFPSB14S	1.93	8.50	150	24
4"	4BMF285PLFPSB14S	3.86	12.00	150	62
6"	6BMF285PLFPSB14S	5.75	15.88	150	150

WELD X WELD – 740 PSI – ANSI 300					
Size	Catalog number	Port	Length	Wall	Weight
2"	2BMW740PLFPSB14S	1.93	11.81	0.154	14
4"	4BMW740PLFPSB14S	3.86	15.35	0.237	37
6"	6BMW740PLFPSB14S	5.75	15.88	0.280	117

WELD X FLANGE – 740 PSI – ANSI 300					
Size	Catalog number	Port	Length	Wall	Weight
2"	2BMWF740PLFPSB14S	1.93	10.16	0.154	21
4"	4BMWF740PLFPSB14S	3.86	13.10	0.237	58
6"	6BMWF740PLFPSB14S	5.75	15.88	0.280	155

FLANGE X FLANGE – 740 PSI – ANSI 300					
Size	Catalog number	Port	Length	ANSI	Weight
2"	2BMF740PLFPSB14S	1.93	8.50	300	28
4"	4BMF740PLFPSB14S	3.86	12.00	300	79
6"	6BMF740PLFPSB14S	5.75	15.88	300	192

Dimensions listed in inch and pound

BROEN reserves the right to change any information included in this catalog without notice.

PIPELINE

FEMALE THREADED END



Valve with 2" operating nut

FEMALE THREADED END – 285 PSI – ANSI 150					
Size	Catalog number	Port	Length	MAOP	Weight
2"	2BMFT285PLRPCB14S	1.57	6.50	285	11
3"	3BMFT285PLRPCB14S	2.48	8.13	285	18
4"	4BMFT285PLRPCB14S	3.10	9.37	285	29

FEMALE THREADED END - 500 PSI					
Size	Catalog number	Port	Length	MAOP	Weight
2"	2BMFT500PLRPCB14S	1.57	6.50	500	11
3"	3BMFT500PLRPCB14S	2.48	8.13	500	17
4"	4BMFT500PLRPCB14S	3.10	9.37	500	29

FEMALE THREADED END – 740 PSI – ANSI 300					
Size	Catalog number	Port	Length	MAOP	Weight
2"	2BMFT740PLRPCB14S	1.57	6.50	740	11

Dimensions listed in inch and pound

PIPELINE

WELD BY MALE THREADED END

FOR FLANGE MACHINING



Valve with curb nut

WELD X MPT THREAD– 285 PSI – ANSI 150					
Size	Catalog number	Port	Length	Wall	Weight
3/4" ⁽¹⁾	3/4BMWM285PLRPSB25S	0.59	9.02	0.113	3
3/4"	3/4BMWM285PLRPSB14S	0.59	9.02	0.113	5
1" ⁽¹⁾	1BMWM285PLRPSB25S	0.79	9.06	0.133	4
1"	1BMWM285PLRPSB14S	0.79	9.06	0.130	6
1-1/4"	5/4BMWM285PLRPCB14S	1.00	10.24	0.140	7
2"	2BMWM285PLRPCB14S	1.54	11.81	0.154	11

WELD X MPT THREAD - 740 PSI - ANSI 300					
Size	Catalog number	Port	Length	Wall	Weight
3/4" ⁽¹⁾	3/4BMWM740PLRPSB25S	0.59	9.02	0.113	3
3/4"	3/4BMWM740PLRPSB14S	0.59	9.02	0.113	5
1" ⁽¹⁾	1BMWM740PLRPSB25S	0.79	9.06	0.133	4
1"	1BMWM740PLRPSB14S	0.79	9.06	0.130	6
1-1/4"	5/4BMWM740PLRPCB14S	1.00	10.24	0.140	7
2"	2BMWM740PLRPCB14S	1.54	11.81	0.154	11

⁽¹⁾ curb nut

PREMIUM FULL PORT FLOATING BALL VALVE

High-end valve made with extra-strong forged components. Short-pattern design is ideal for metering and regulating stations.

Manufactured from high strength machined carbon steel material, they can be used in below ground or above ground applications.

These valves feature:

- Stainless steel balls and stem standard
- Quarter-turn operations
- Locking plate with POWERSTOPS™ 600 ft/lbs
- Seats of 25% carbonized PTFE (Teflon™) (G-453) rated to -20°F
- Zinc coated stem bearings
- Tested per API-6D requirements
- Serial numbered for full traceability



BROEN reserves the right to change any information included in this catalog without notice.

WELD X WELD – 285 PSI – ANSI 150					
Size	Catalog number	Port	Length	Wall	Weight
2"	2BMW285PRFPCB14S	1.93	7.00	0.154	13
3"	3BMW285PRFPCB14S	3.07	9.00	0.216	23
4"	4BMW285PRFPCB14S	3.86	9.75	0.237	35
6"	6BMW285PRFPCB14S	5.75	15.50	0.280	110
8"	8BMW285BFPCBHGS	7.87	20.50	0.322	236

WELD X WELD – 740 PSI – ANSI 300					
Size	Catalog number	Port	Length	Wall	Weight
2"	2BMW740PRFPCB14S	1.93	7.00	0.154	13
3"	3BMW740PRFPCB14S	3.07	9.00	0.216	23
4"	4BMW740PRFPCB14S	3.86	9.75	0.237	35
6"	6BMW740PRFPCB14S	5.75	15.5	0.280	110

WELD X FLANGE – 285 PSI – ANSI 150					
Size	Catalog number	Port	Length	Wall	Weight
2"	2BMWF285PRFPCB14S	1.93	7.00	0.154	17
3"	3BMWF285PRFPCB14S	3.07	9.20	0.216	32
4"	4BMWF285PRFPCB14S	3.86	10.39	0.237	44
6"	6BMWF285PRFPCB14S	5.75	15.50	0.280	135
8"	8BMWF285BFPCBHGS	7.87	19.25	0.322	266

WELD X FLANGE – 740 PSI – ANSI 300					
Size	Catalog number	Port	Length	Wall	Weight
2"	2BMWF740PRFPCB14S	1.93	7.75	0.154	19
3"	3BMWF740PRFPCB14S	3.07	8.50	0.216	37
4"	4BMWF740PRFPCB14S	3.86	10.88	0.237	55
6"	6BMWF740PRFPCB14S	5.75	15.69	0.280	147

FLANGE X FLANGE – 285 PSI – ANSI 150					
Size	Catalog number	Port	Length	ANSI	Weight
2"	2BMF285PRFPCB14S	1.93	7.00	150	22
3"	3BMF285PRFPCB14S	3.07	8.00	150	41
4"	4BMF285PRFPCB14S	3.86	9.00	150	57
6"	6BMF285PRFPCB14S	5.75	15.50	150	150
8"	8BMF285BFPCBHGS	7.87	18.00	150	296

FLANGE X FLANGE – 740 PSI – ANSI 300					
Size	Catalog number	Port	Length	ANSI	Weight
2"	2BMF740PRFPCB14S	1.93	8.50	300	26
3"	3BMF740PRFPCB14S	3.07	11.13	300	50
4"	4BMF740PRFPCB14S	3.86	12.00	300	71
6"	6BMF740PRFPCB14S	5.75	15.88	300	180

Dimensions listed in inch and pound

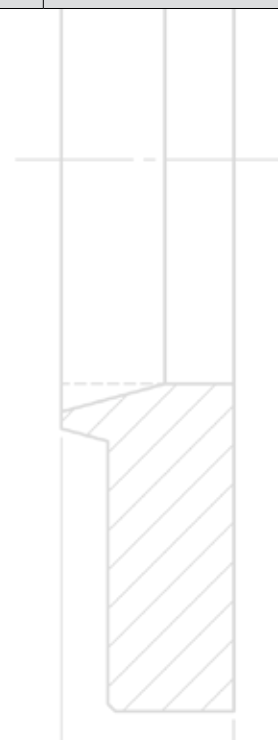
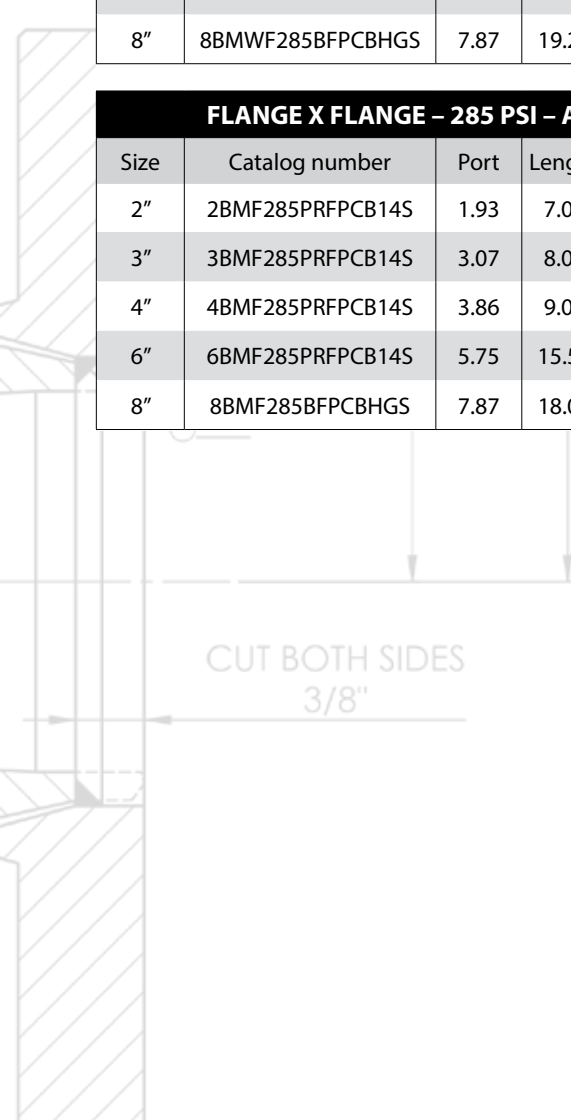

BROEN reserves the right to change any information included in this catalog without notice.

PREMIUM - BALLOTAP™ HOT TAPPING BALL VALVE

Fully welded, machined carbon steel full port ball valves designed with a weld end and a threaded end that accepts a special BALLOTAP™ threaded flange for use in tapping under pressure of natural gas pipelines.

Valve works with all common drilling and tapping machines currently on the market. O-ring seal in flange allows for pressure testing of weld prior to tapping:

- Stainless steel balls and stem standard
- 2" square nut operated
- Locking plate with POWERSTOPS™ to prevent over turning
- Seats of 25% carbonized PTFE (Teflon™) (G-453) rated to -20°F
- Zinc coated stem bearings
- Tested per API-6D requirements
- Serial numbered for full traceability
- Full port design

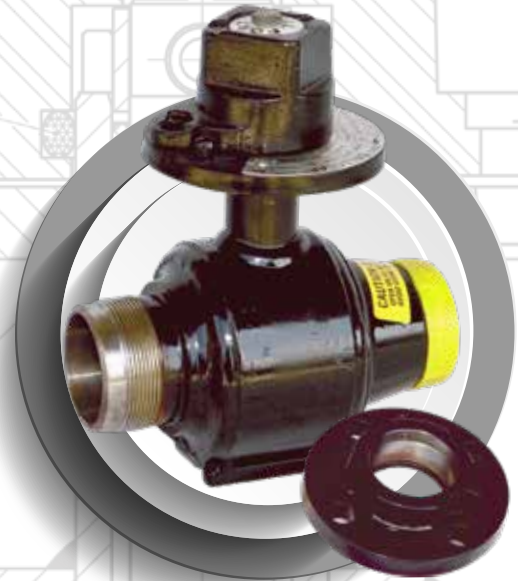

BALLOTAP™ VALVES – 285 PSI – ANSI 150					
Size	Catalog number	Port	Length	Wall	Weight
2"	2BMHT285PRFPCB14S	1.93	7.00	0.154	13
4"	4BMHT285PRFPCB14S	3.86	10.39	0.237	33
6"	6BMHT285PRFPCB14S	5.75	15.50	0.280	110

BALLOTAP™ – REMOVABLE FLANGES – 285 PSI – ANSI 150			
Size	Catalog number	ANSI CLASS	Weight
2"	2F150BT	150	5
4"	4F150BT	150	13
6"	6F150BT	150	19

BALLOTAP™ VALVES – 740 PSI – ANSI 300					
Size	Catalog number	Port	Length	Wall	Weight
2"	2BMHT740PRFPCB14S	1.93	7.00	0.154	13
4"	4BMHT740PRFPCB14S	3.86	10.39	0.237	33
6"	6BMHT740PRFPCB14S	5.75	15.50	0.280	110

BALLOTAP™ – REMOVABLE FLANGES – 740 PSI – ANSI 300			
Size	Catalog number	ANSI	Weight
2"	2F300BT	300	7
4"	4F300BT	300	22
6"	6F300BT	300	39

Dimensions listed in inch and pound

BROEN reserves the right to change any information included in this catalog without notice.

UTILITY

FLANGED BALL VALVES

Cost-effective short pattern flanged end ball valve. Ideal to replace plug and iron body valves.



- Stainless steel balls and stem standard
- Wrench nut or lever handle operated
- Locking lugs
- Seats of 25% carbonized PTFE (Teflon™) (G-453) rated to -20°F
- Zinc coated stem bearings
- Tested per API-6D requirements
- Serial numbered for full traceability
- High strength boiler plate flanges drilled to ANSI 150 pattern

RAISED FACE

285 PSI – ANSI 150 – WITH WRENCH NUT

Size	Catalog number	Port	Length	ANSI	Weight
2"	2BMF285UVRPCB03S	1.54	7.00	150	11
3"	3BMF285UVRPCB03S	2.48	8.00	150	19
4"	4BMF285UVRPCB03S	3.07	9.00	150	33
6"	6BMF285UVRPCB03S	4.80	10.5	150	68

285 PSI – ANSI 150 – WITH HANDLE

Size	Catalog number	Port	Length	ANSI	Weight
2"	2BMF285UVRPCB01S	1.54	7.00	150	11
3"	3BMF285UVRPCB01S	2.48	8.00	150	19
4"	4BMF285UVRPCB01S	3.07	9.00	150	34
6"	6BMF285UVRPCB01S	4.80	10.5	150	72

FLAT FACE

285 PSI – ANSI 150 – WITH WRENCH NUT

Size	Catalog number	Port	Length	ANSI	Weight
2"	2BMF285UVRPCB03SFF	1.54	7.00	150	11
3"	3BMF285UVRPCB03SFF	2.48	8.00	150	19
4"	4BMF285UVRPCB03SFF	3.07	9.00	150	32
6"	6BMF285UVRPCB03SFF	4.80	10.5	150	68

285 PSI – ANSI 150 – WITH HANDLE

Size	Catalog number	Port	Length	ANSI	Weight
2"	2BMF285UVRPCB01SFF	1.54	7.00	150	11
3"	3BMF285UVRPCB01SFF	2.48	8.00	150	19
4"	4BMF285UVRPCB01SFF	3.07	9.00	150	33
6"	6BMF285UVRPCB01SFF	4.80	10.5	150	71

BROEN reserves the right to change any information included in this catalog without notice.

Dimensions listed in inch and pound

TURNING TORQUE

FOR 2" - 8" BROEN BALLOMAX® REDUCED PORT AND FULL PORT

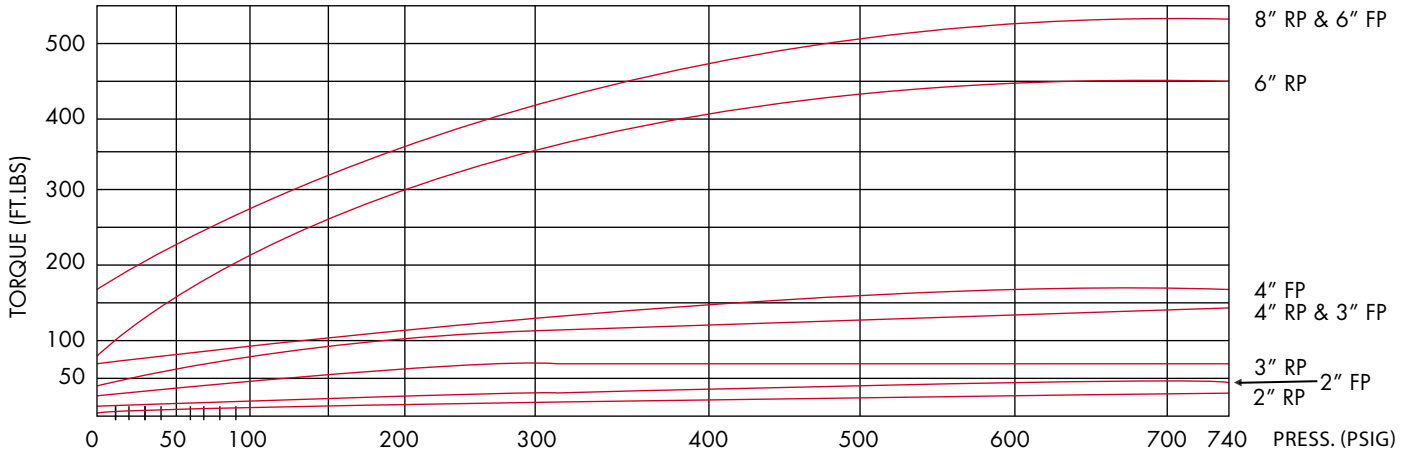

The torque must be considered as a recommended torque. The torque is derived from measurements taken on newly produced valves. The torque is a break away torque for a closed, but just activated valve. It should be noted: For a valve, which has not been activated for a long period of time, the listed turning torques could be up to 1-1/2 times greater.

PRESSURE LOSS DIAGRAM

FULL PORT BROEN BALLOMAX® BALL VALVES

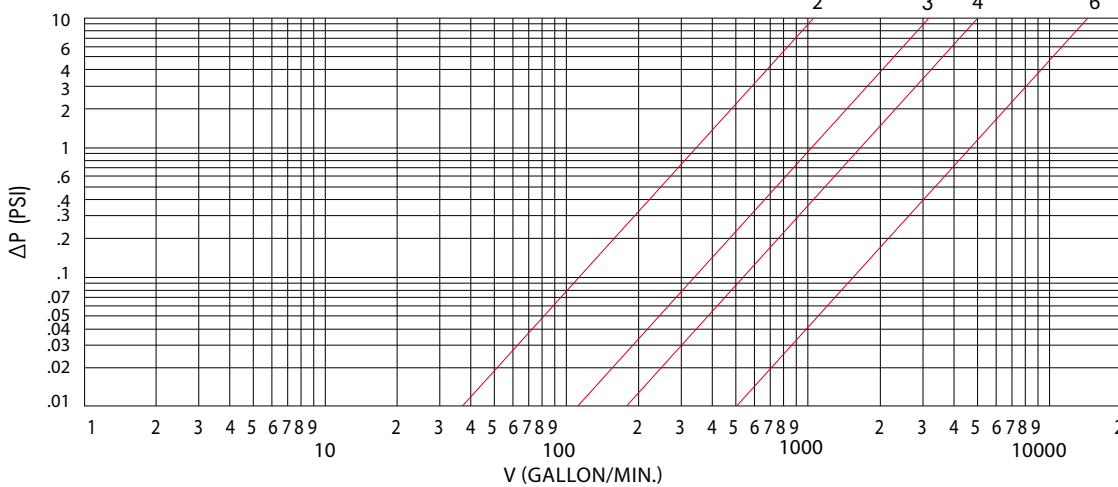

$$C_v = \frac{V}{\sqrt{\Delta P}}$$

v = Flow rate in gallon/min
 ΔP = Pressure drop in PSI

Valve	2"	3"	4"	6"
Cv	355	1100	1850	4825

MEDIUM:
 Water with specific gravity of 1.

PRESSURE LOSS DIAGRAM

REGULAR PORT BROEN BALLOMAX® BALL VALVES

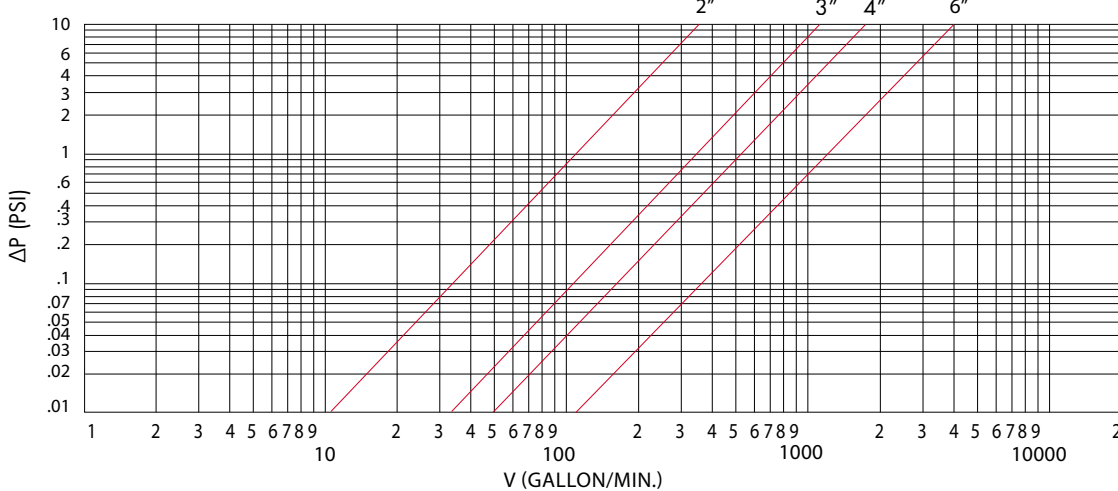

$$C_v = \frac{V}{\sqrt{\Delta P}}$$

v = Flow rate in gallon/min
 ΔP = Pressure drop in PSI

Valve	2"	3"	4"	6"
Cv	116	324	520	1272

MEDIUM:
 Water with specific gravity of 1.

BROEN reserves the right to change any information included in this catalog without notice.



BROEN

VALVE TECHNOLOGIES



CONTACT A BROEN REPRESENTATIVE TODAY

BROEN INC.

27657 Commerce Oaks Drive, Oak Ridge North, Texas, 77385 USA

+1 713.300.0480 | info@BROEN.com | www.BROEN.us

