

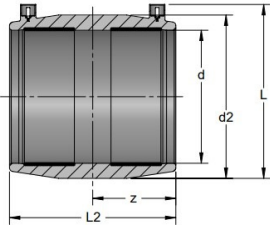

**ELECTROFUSION COUPLING:
PE2708, IPS, 4.7R Pin**

- Pin Type: 4.7R (4.7 Pin with Resistor)
- Meets ASTM D2513
- Approval: ASTM F1055
- Certified to CSA B137.4.1



Size (inch)	GF Code	weight (lb)	d (inch)	d2 (inch)	z (inch)	L (inch)	L2 (inch)	Box Qty
1/2	360 000 886	0.1	0.84	1.38	1.42	2.15	2.98	40
3/4	360 000 890	0.2	1.07	1.72	1.36	2.32	2.84	25
1	360 000 894	0.1	1.33	1.88	1.57	2.56	3.30	25
1-1/4	360 000 898	0.2	1.68	2.27	1.82	3.00	3.70	50
1-1/2	360 000 900	0.4	1.92	2.60	1.89	3.27	3.70	35
2	360 000 921	0.4	2.41	3.16	2.09	3.82	4.31	25
3	360 000 934	1.1	3.55	4.54	2.72	5.18	5.59	36
4	360 000 937	1.6	4.53	5.57	3.00	6.51	6.14	10
6	360 000 941	4.4	6.66	8.17	4.10	8.70	8.35	8
8	360 000 945	8.4	8.68	10.63	4.70	11.20	9.48	4

The technical data are not binding. They neither constitute expressly warranted characteristics nor guaranteed properties nor a guaranteed durability. They are subject to modification. Our General Terms of Sale apply.

Georg Fischer Piping Systems Ltd, Postfach, CH-8201 Schaffhausen/Switzerland Phone +41 -(0)52-631 1111 e-mail: info.ps@georgfischer.com Internet: <http://www.gfps.com>